

Do not scale from this drawing, use stated dimensions only.

REFERENCE:

This map is reproduced from Ordnance Survey material by Mouchel Consulting Limited on behalf of the Highways Agency, with the permission of the Controller of Her Majesty's Stationery Office. © Crown copyright. Ordnance Survey is a registered trademark of Ordnance Survey Limited. The information on this drawing is for reference only. It is not to be used for the prosecution of civil proceedings. License Number: GD 272663

- Key:
- Existing road marking to be renewed
 - Proposed road markings
 - Road markings to be removed
 - Road carriageway surfacing
 - Proposed sign and reference number. See separate sign schedules for post, plate and foundation details.
 - RS1 separate sign schedules for post, plate and foundation details.

- Signs, Signals and Ducting
- Signal post
 - B Primary aspect
 - ⊙ Secondary aspect
 - ⊕ Pole numbers.
- Notes:
1. All dimensions are indicative and based on OS mapping. As such, some minor adjustment may be required by Engineer on site.
 2. All excavations for sign foundations to be hand dug.
 3. Sign locations are indicative. All signs to be installed so that they do not conflict with statutory undertakers plant.
 4. All dimensions in millimetres unless stated otherwise.
 5. All road markings to be applied while thermoplastic solvent.
 6. Lane lines on exit slip to be renewed after High Friction Surfacing (omitted from drawing for clarity).
 7. All road markings to be in accordance with TSRGD 2002 and TSM Chapter 5.
 8. Exact locations for Sign Ref 4 to be agreed on site with a Mouchel Engineer.
 9. Oxshott Road overbridge has been removed for clarity.

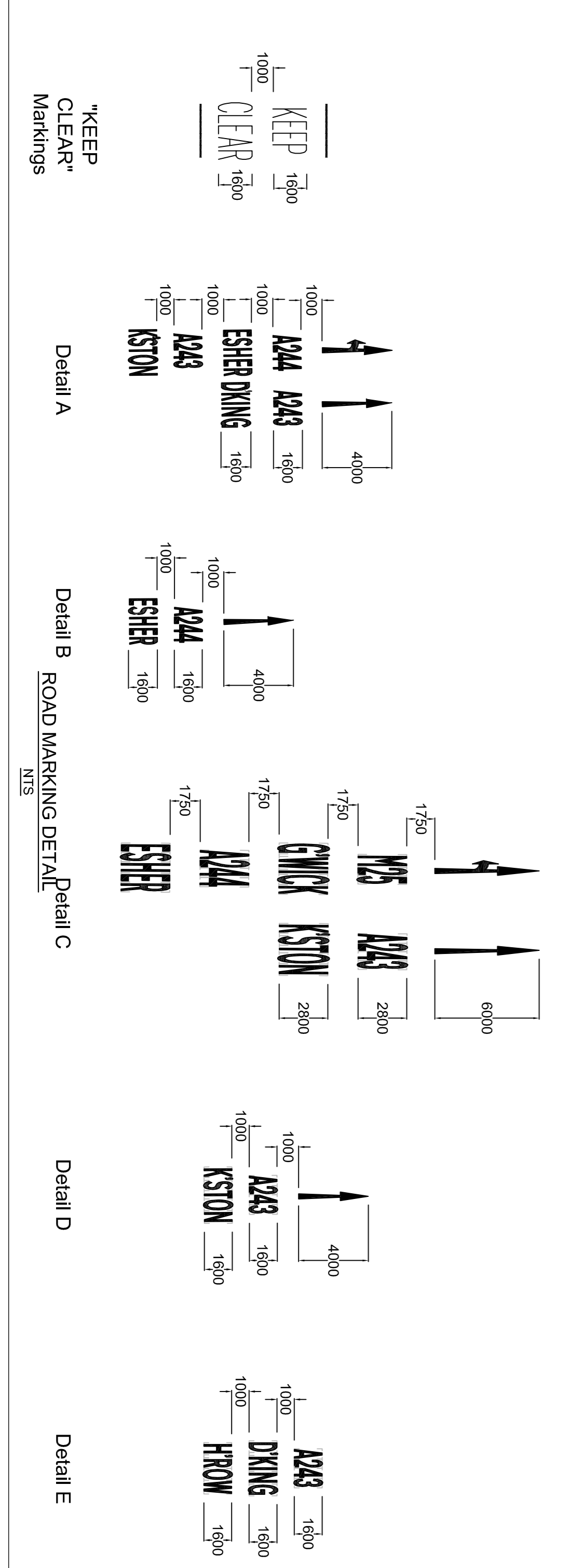
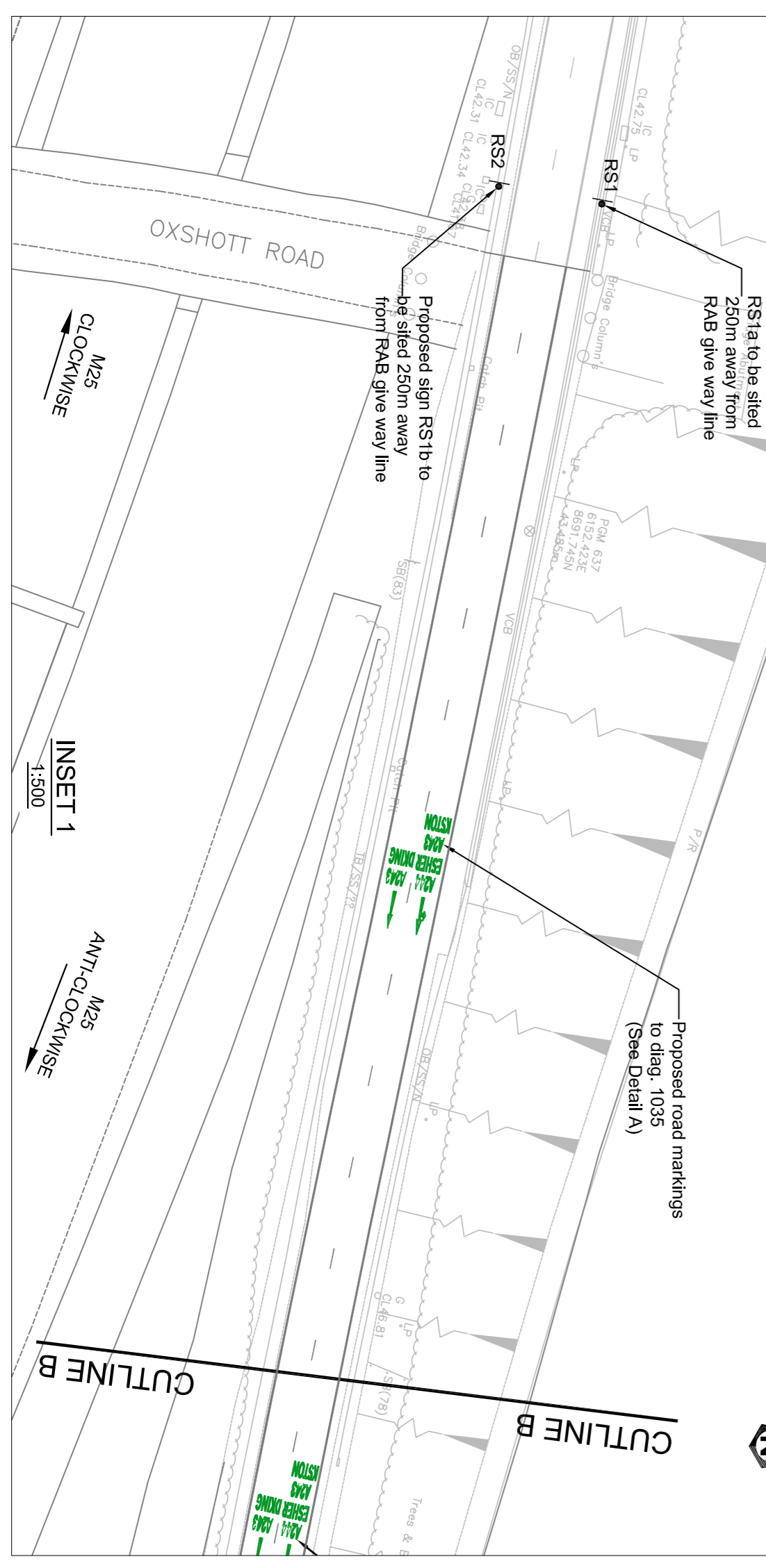
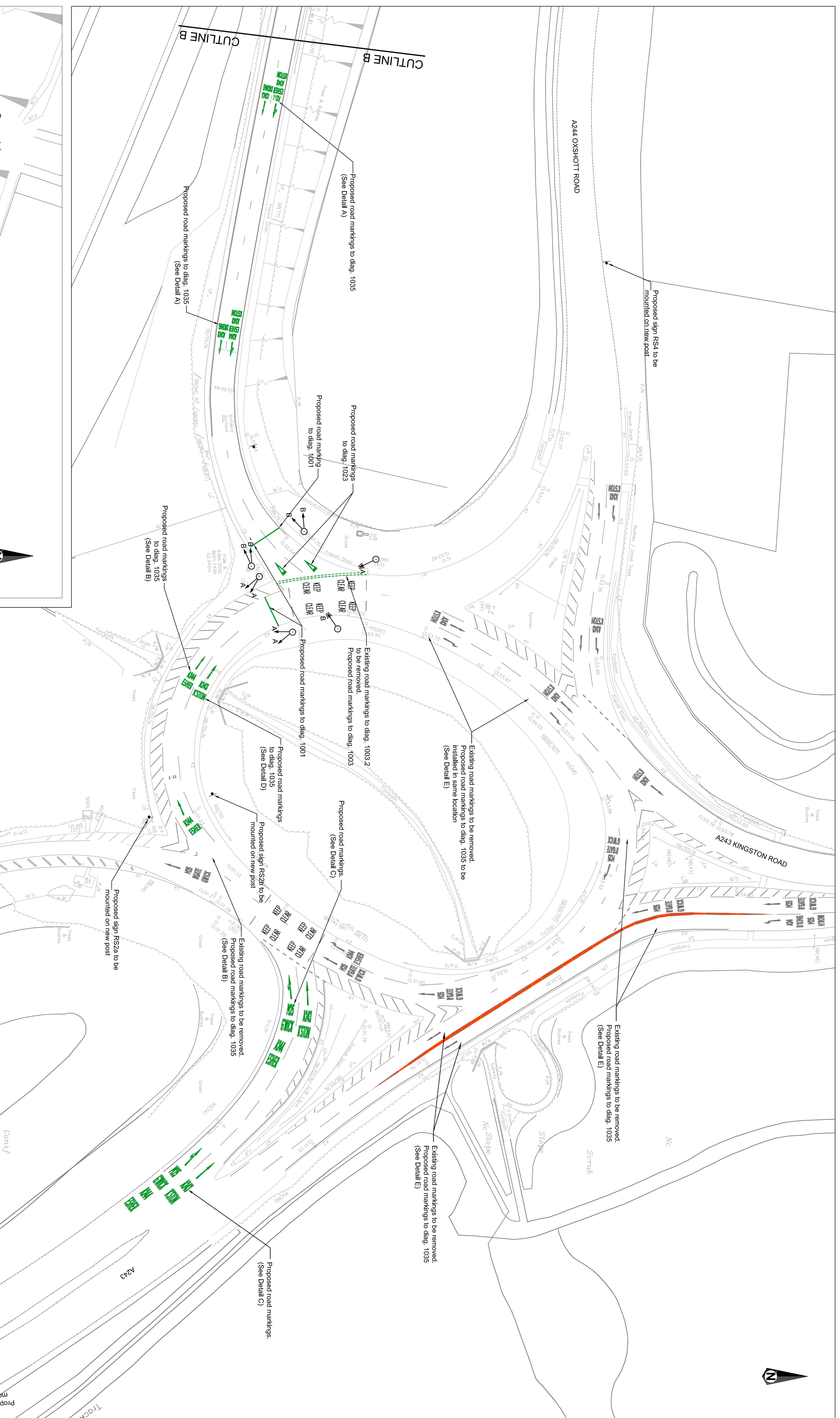

AGENT: **mouchel** M25 S P H E R E

CLIENT: **HA HIGHWAYS AGENCY**

PROJECT: M25 JUNCTION 9B SIGNALISATION

TITLE: SCHEME OVERVIEW

SCALE: N.T.S. A1

DATE: NOV 2008

DESIGN: NOV 2008

CHECKED: NOV 2008

APPROVED: NOV 2008

CAD REFERENCE: 710707-001-1200-020

REV: A01 PRELIMINARY ISSUE

DESCRIPTION: BOWL OCT 08

SIGNED/DATE: [Signature] [Date]

DATE: NOV 2008

DESIGN: NOV 2008

CHECKED: NOV 2008

APPROVED: NOV 2008

CAD REFERENCE: 710707-001-1200-020

PROJECT: M25 JUNCTION 9B SIGNALISATION

TITLE: SCHEME OVERVIEW

SCALE: N.T.S. A1

DATE: NOV 2008

DESIGN: NOV 2008

CHECKED: NOV 2008

APPROVED: NOV 2008

CAD REFERENCE: 710707-001-1200-020